

Name:		
Location:		
Email:		
Phone:	Cell:	
Fax:	Cover: HL13 HYBRID/KEDER	
Length:	Centers:	Arc: 120'-0"
Rafter Coating: ASTM-A123 Hot Dip Galvanized 3.9 mils Zinc		
Foundation:		

100' PROFILE PRO-ADVANTAGE TRUSS

THIS DOCUMENT CONTAINS
INFORMATION PROPRIETARY TO
ACCU-STEEL INC. IT SHALL NOT BE
REPRODUCED, USED, OR DISCLOSED
WITHOUT PRIOR WRITTEN
PERMISSION OF ACCU-STEEL INC.



Notes:

Date: 2/23/2012
Project:
Drawn By: JCB
Sales #

1-877-338-6936
www.asicoverbuildings.com
sales@asicoverbuildings.com

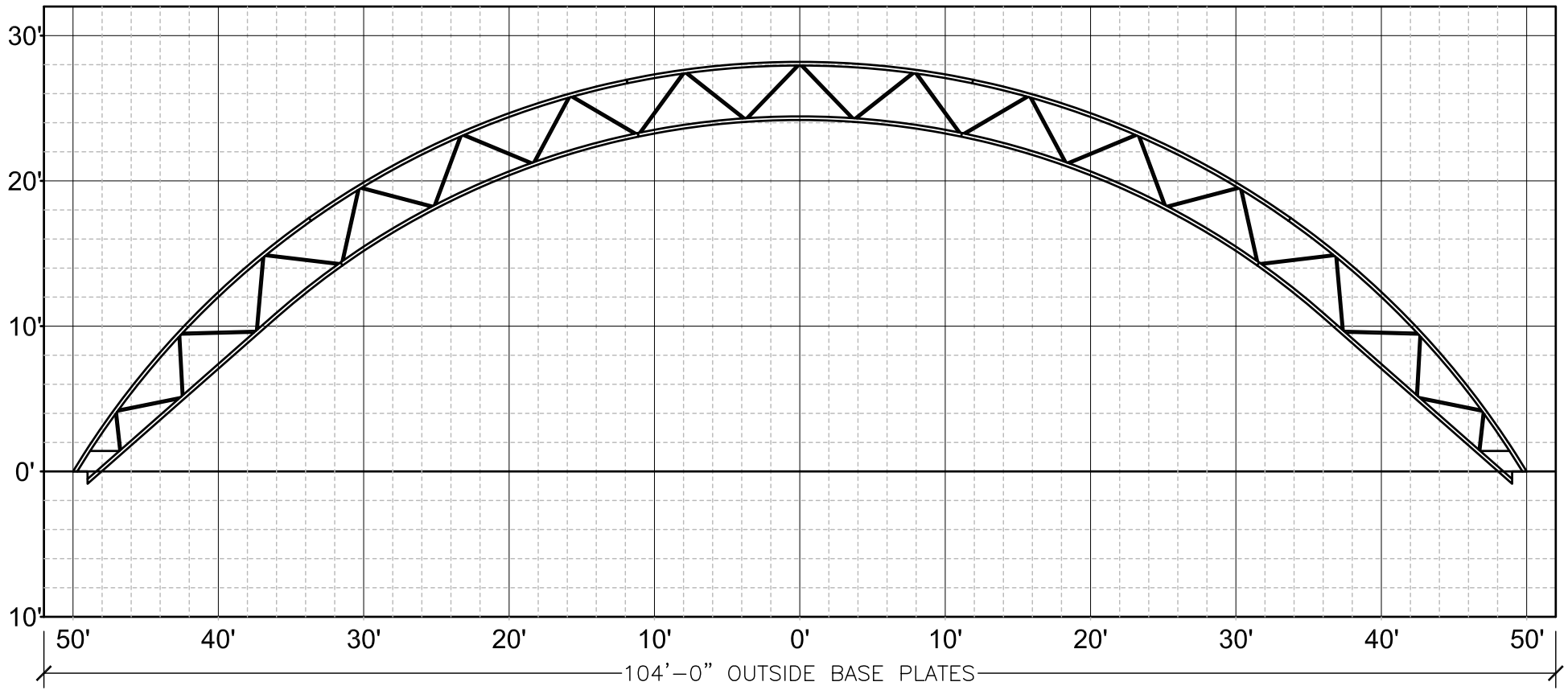

2'x2' GRID